

## Box Properties

--Description--

Name: PR08

Type: Passive Radiator Box

Shape: Prism, square

--Box Parameters--

Vb = 1 liters

V(total) = 1.129 liters

QL = 7

F3 = 45.53 Hz

Fill = minimal

--Passive Radiators--

No. of Passive Radiators = 1

Fs = 11.2 Hz

Qms = 7.008

Vas = 18.57 liters

Cms = 10.09 mm/N

Mms = 20 g

Rms = 0.201 kg/s

Sd = 36 sq.cm

## Driver Properties

--Description--

Name: W3-1876S

Type: Standard one-way driver

--Configuration--

**No. of Drivers = 1**

--Mechanical Parameters--

Fs = 52.8 Hz

Qms = 3.273

Vas = 0.889 liters

Cms = 0.859 mm/N

Mms = 10.58 g

Rms = 1.073 kg/s

Xmax = 3 mm

Xmech = 4.5 mm

P-Dia = 58.63 mm

Sd = 27 sq.cm

P-Vd = 0.0081 liters

--Electrical Parameters--

Qes = 0.455

Re = 3.6 ohms

Le = 0.153 mH

Z = 4 ohms

BL = 5.27 Tm

Pe = 15 watts

--Electromech. Parameters--

Qts = 0.399

no = 0.0277 %

1-W SPL = 76.63 dB

2.83-V SPL = 80.1 dB



### Wiring Diagram

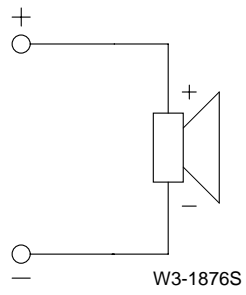

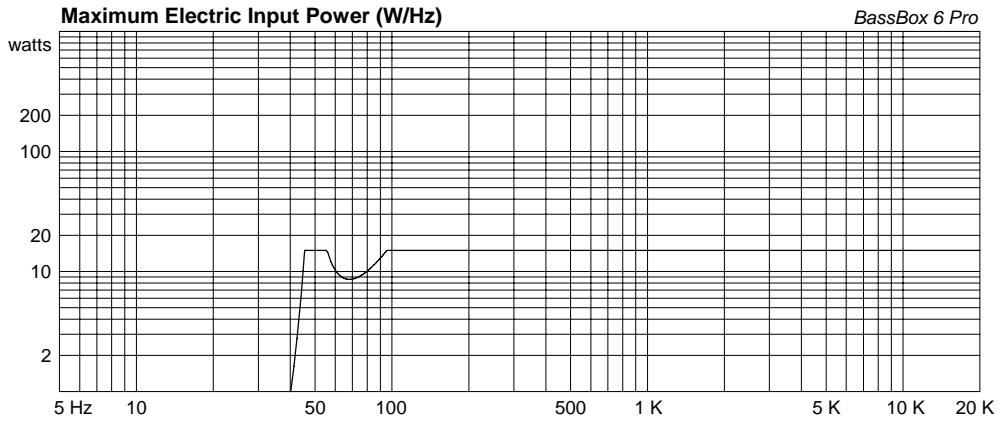
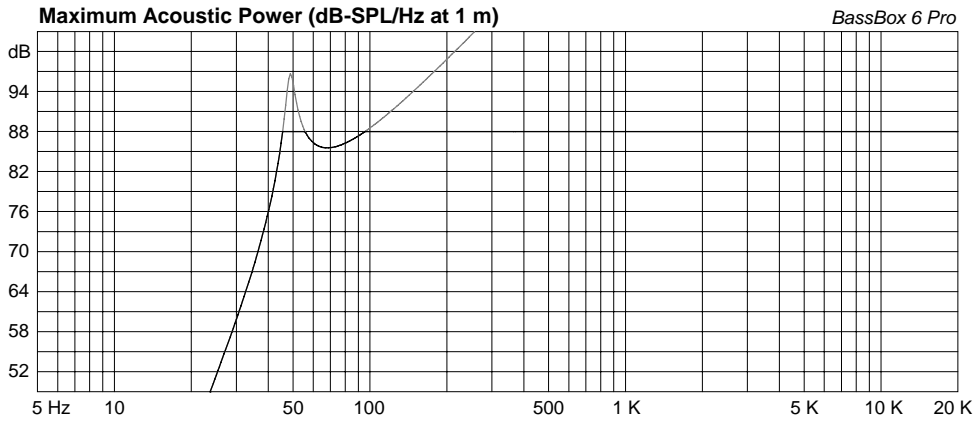
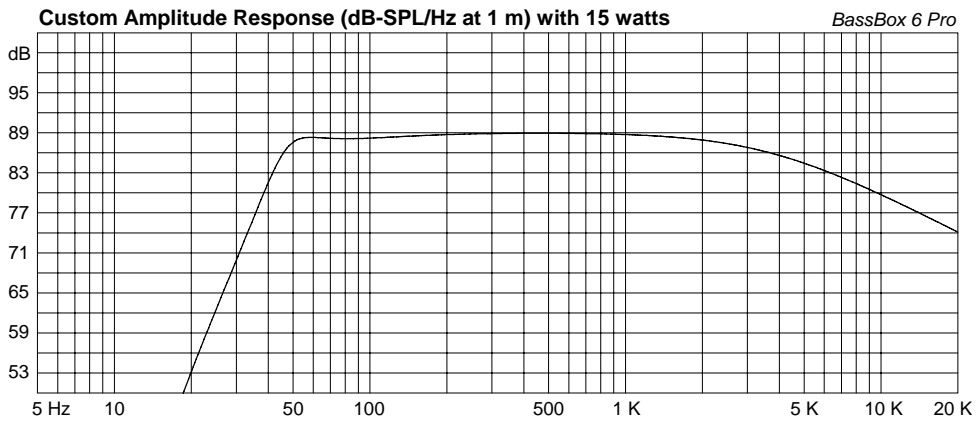
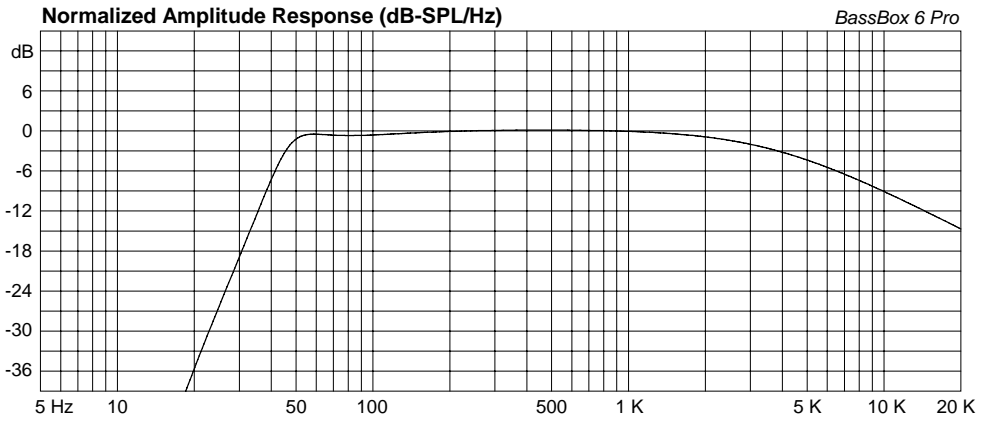

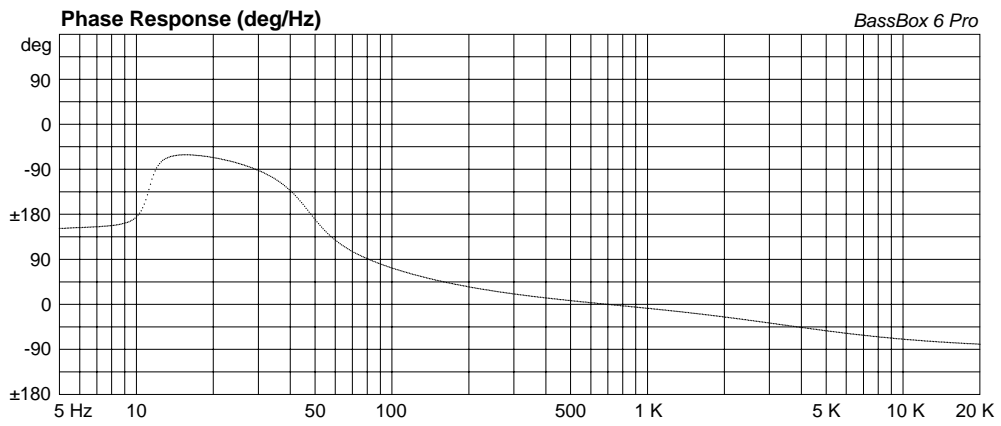
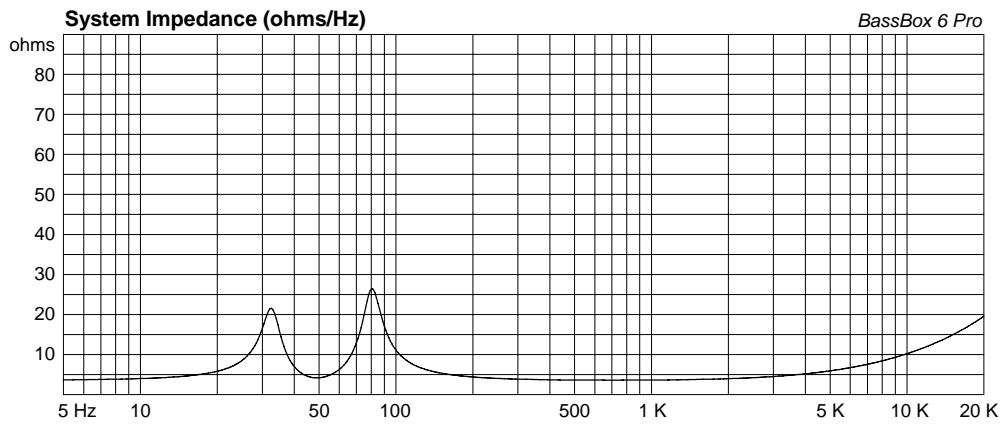
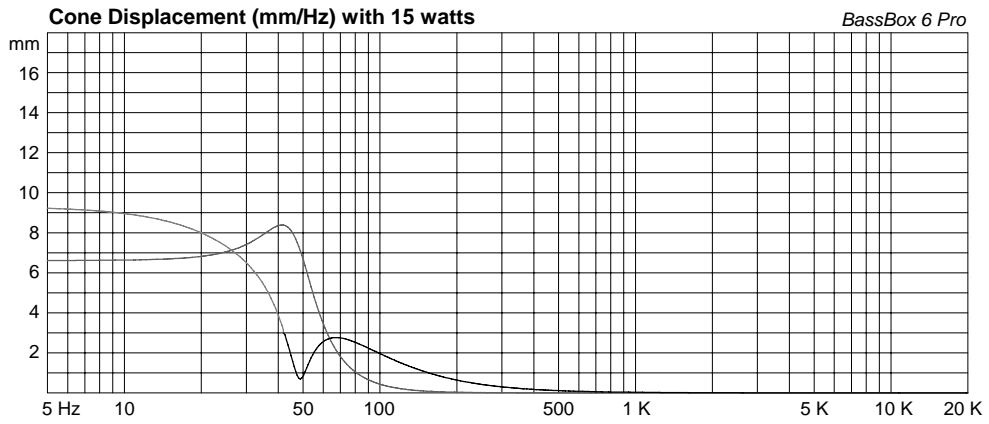

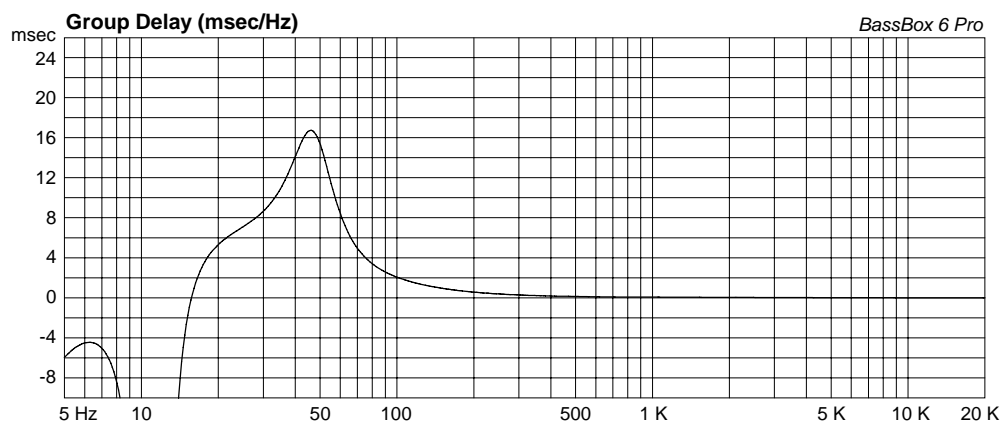

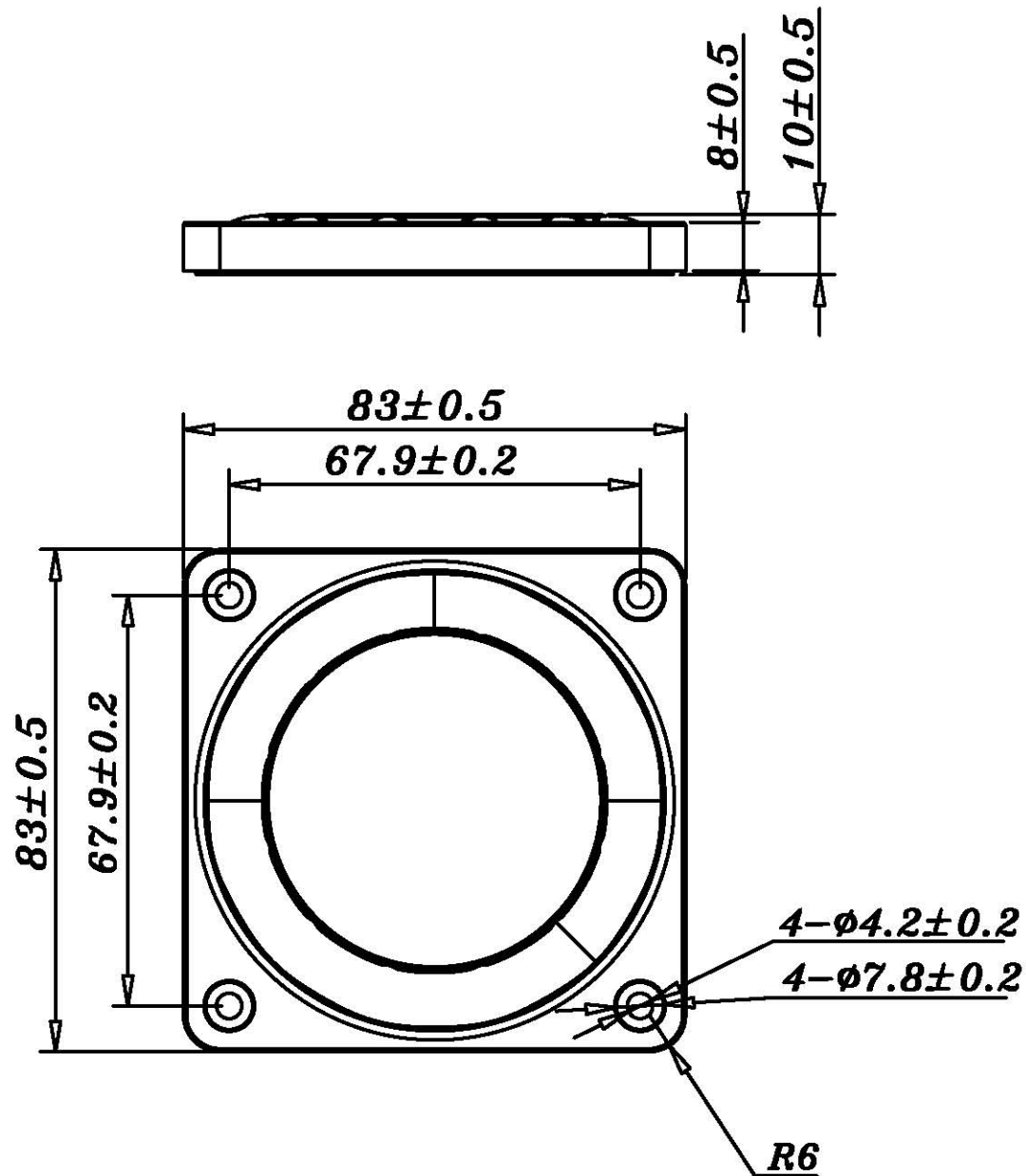

Material(材质):Rubber

**TB**  
speaker

**PR08**

Rev:R01

Date : 2015-09-07